

SafeStore Assembly Guide

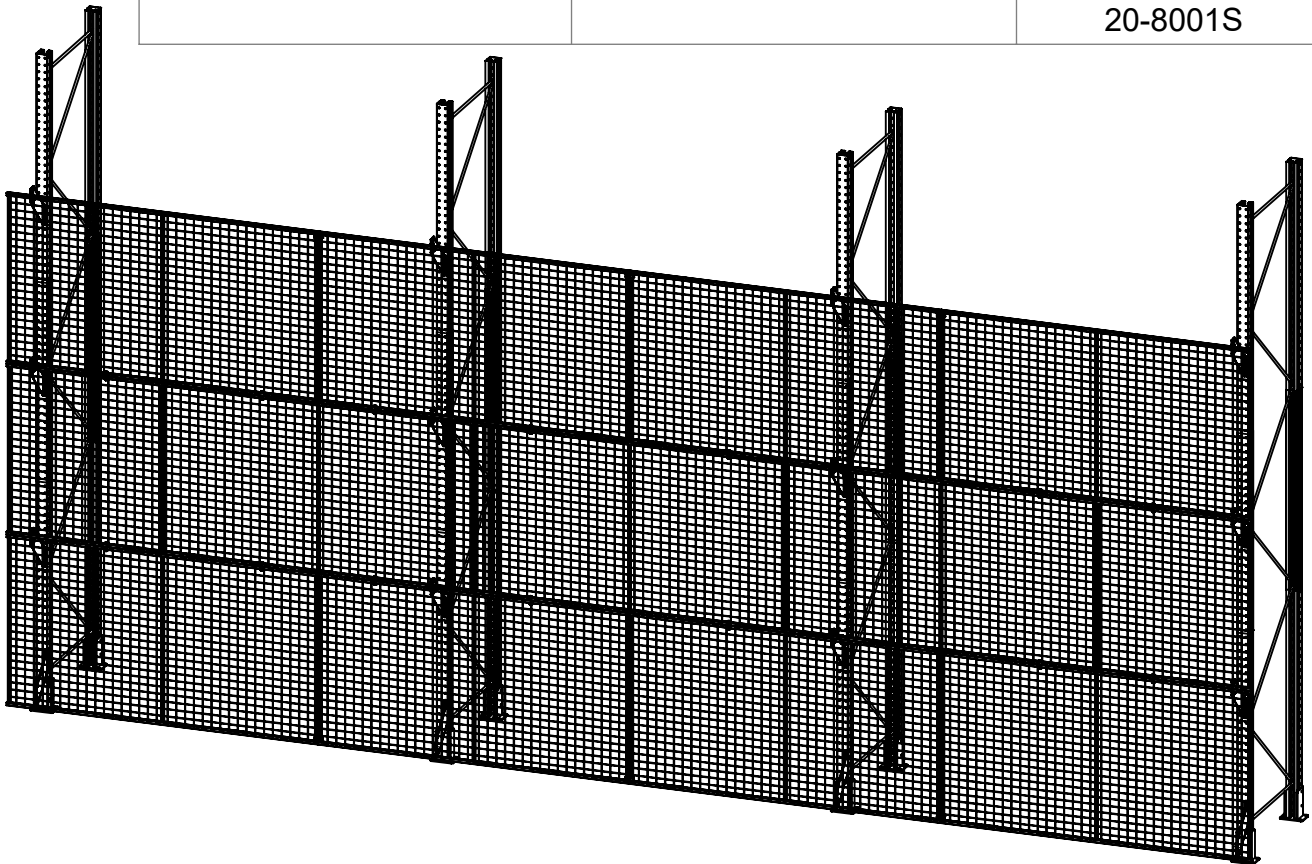

Date: 2022-11-25	Version C.2	Axellent AB	BG инструкции за монтаж CZ Montážní návod DE Montageanleitung DK Monteringsvejledning EE Paigaldusjuhendid ES Instrucciones de montaje FI Kokoamisohje FR Les instructions d'assemblage GR οδηγίες συναρμολόγησης HU Összeszerelési utasítások IE Treoracha cóimeála IT Istruzioni di montaggio	LT Montavimo instrukcijos LV Montāžas instrukcijas MT Istruzzjonijiet għall-immuntar NL Montage-instructies PL Instrukcje składowania PT Instruções de montagem RO Instrucțiunile de asamblare SE Monteringsanvisningar SI Navodila za montažo SK Návod na montáž UK Assembly guide

Technical drawing of a square mesh. The main drawing shows a square grid with a height of 1100 and a width labeled 'X'. A detail view on the right shows a cross-section of the mesh, with a width of 19 and a height of 1100. The detail view also shows a vertical scale with markings at 1100, 1017,5, 700, 400, 82,5, and 0. The mesh is labeled 413/312-XXX110 and 4xØ10.

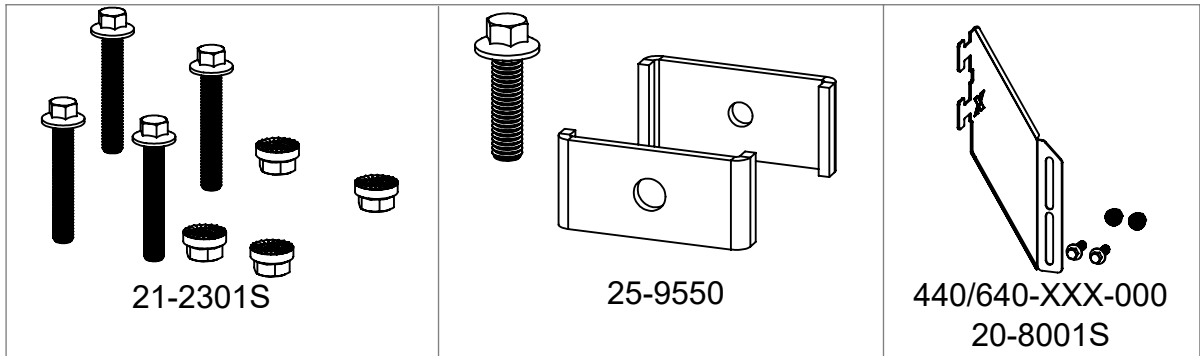
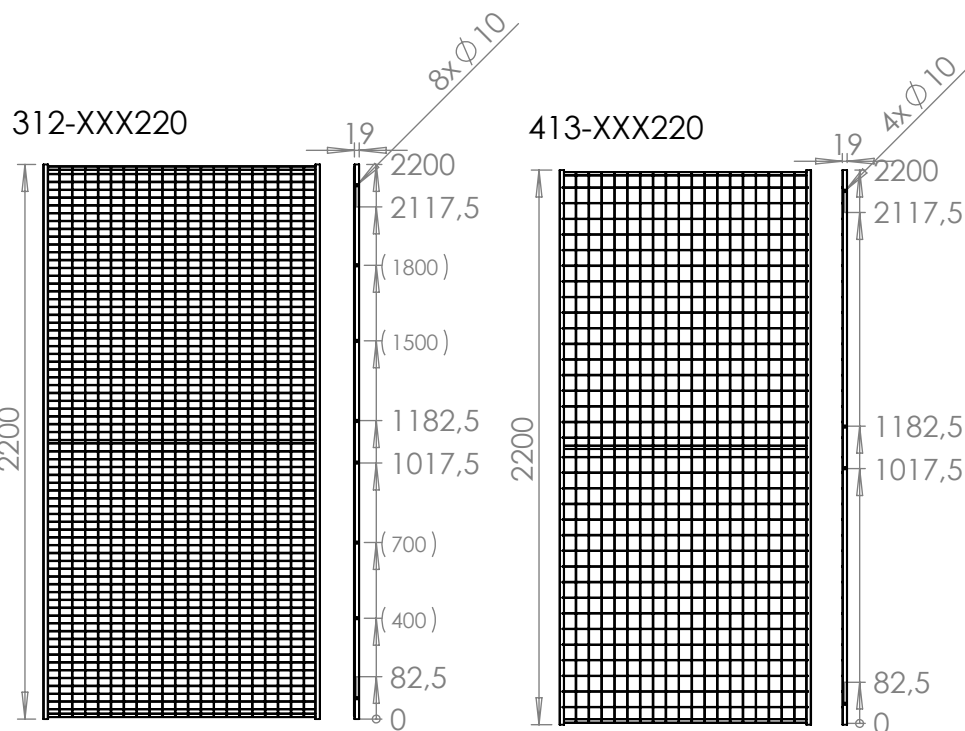

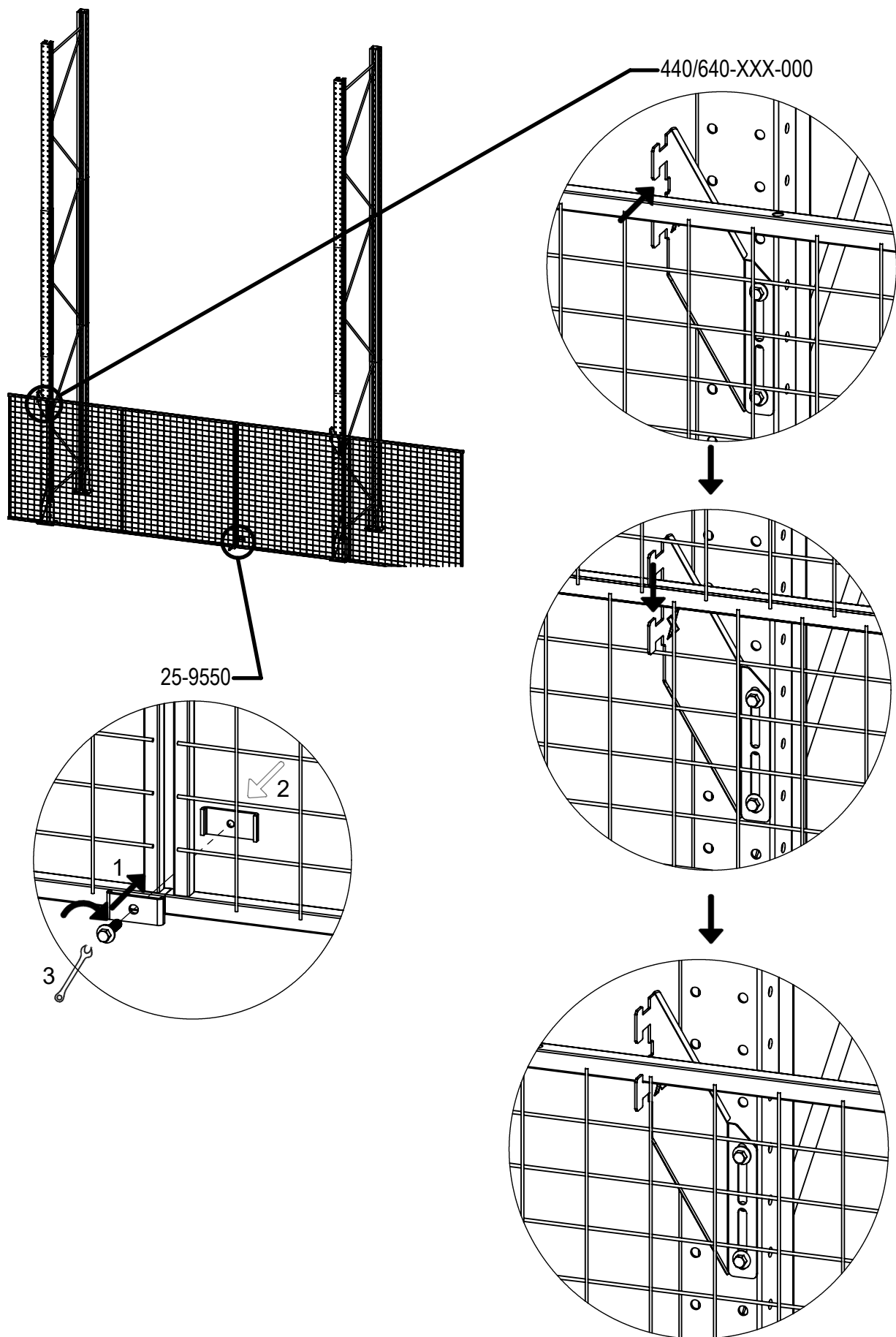

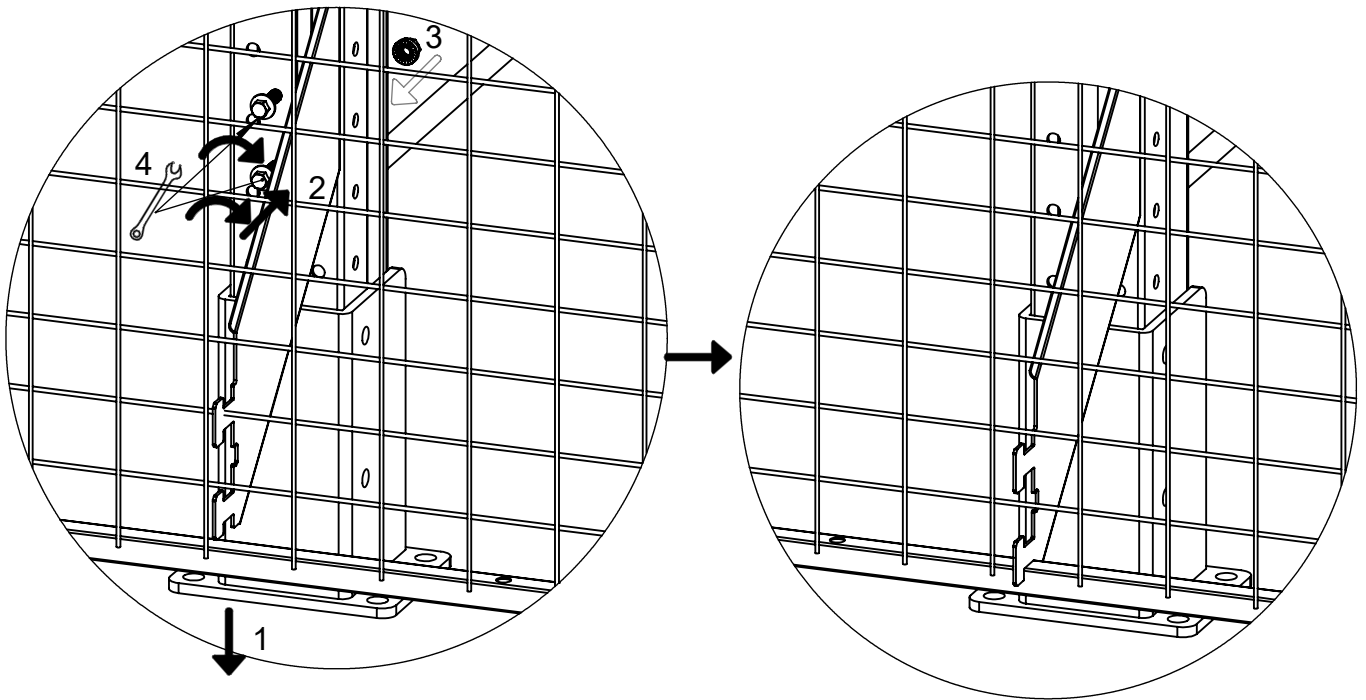
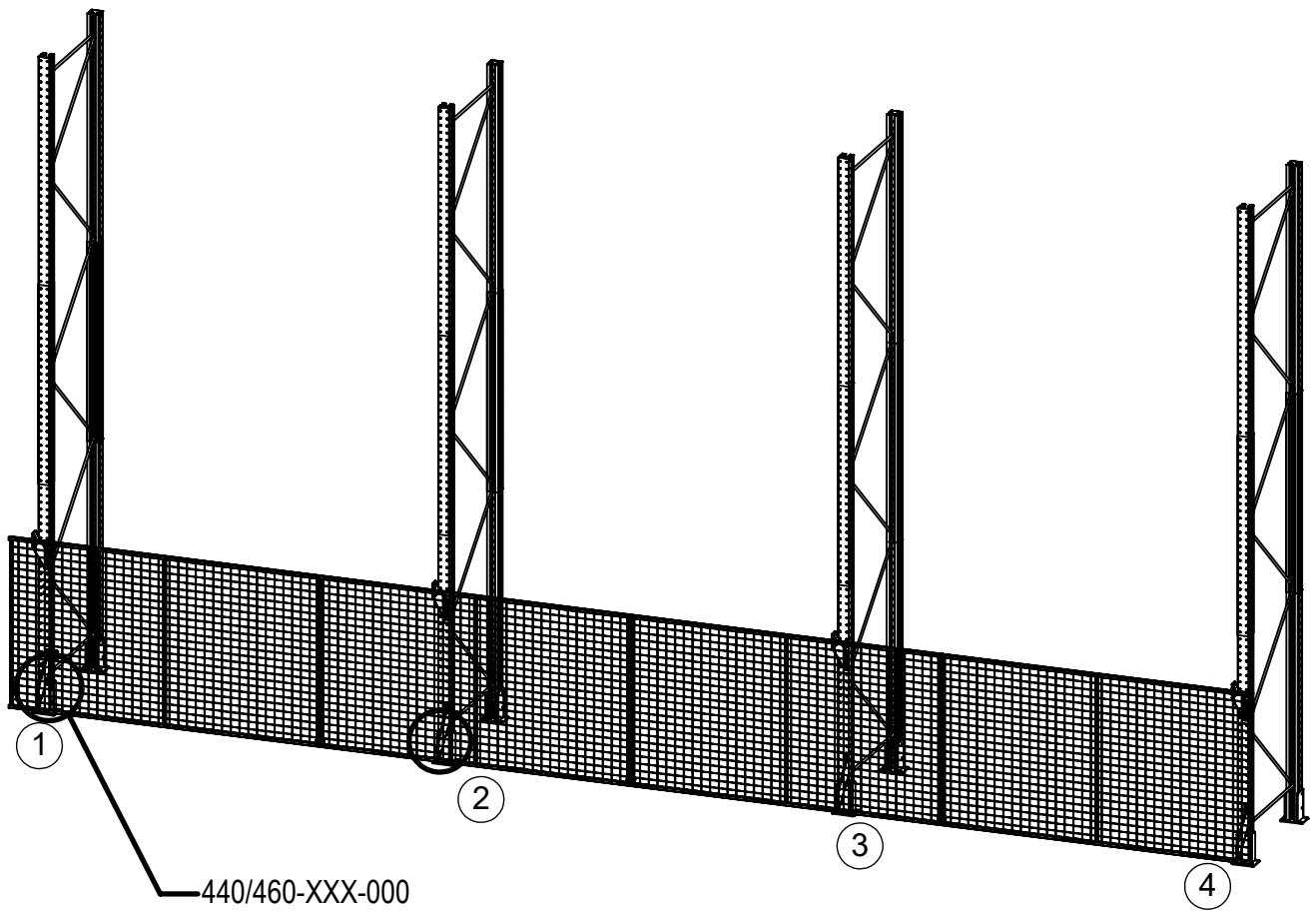

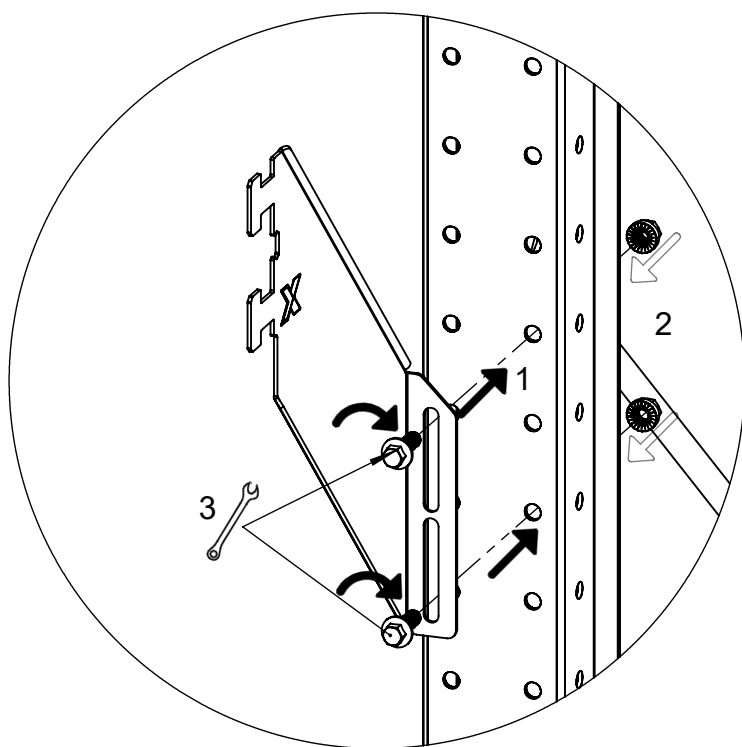
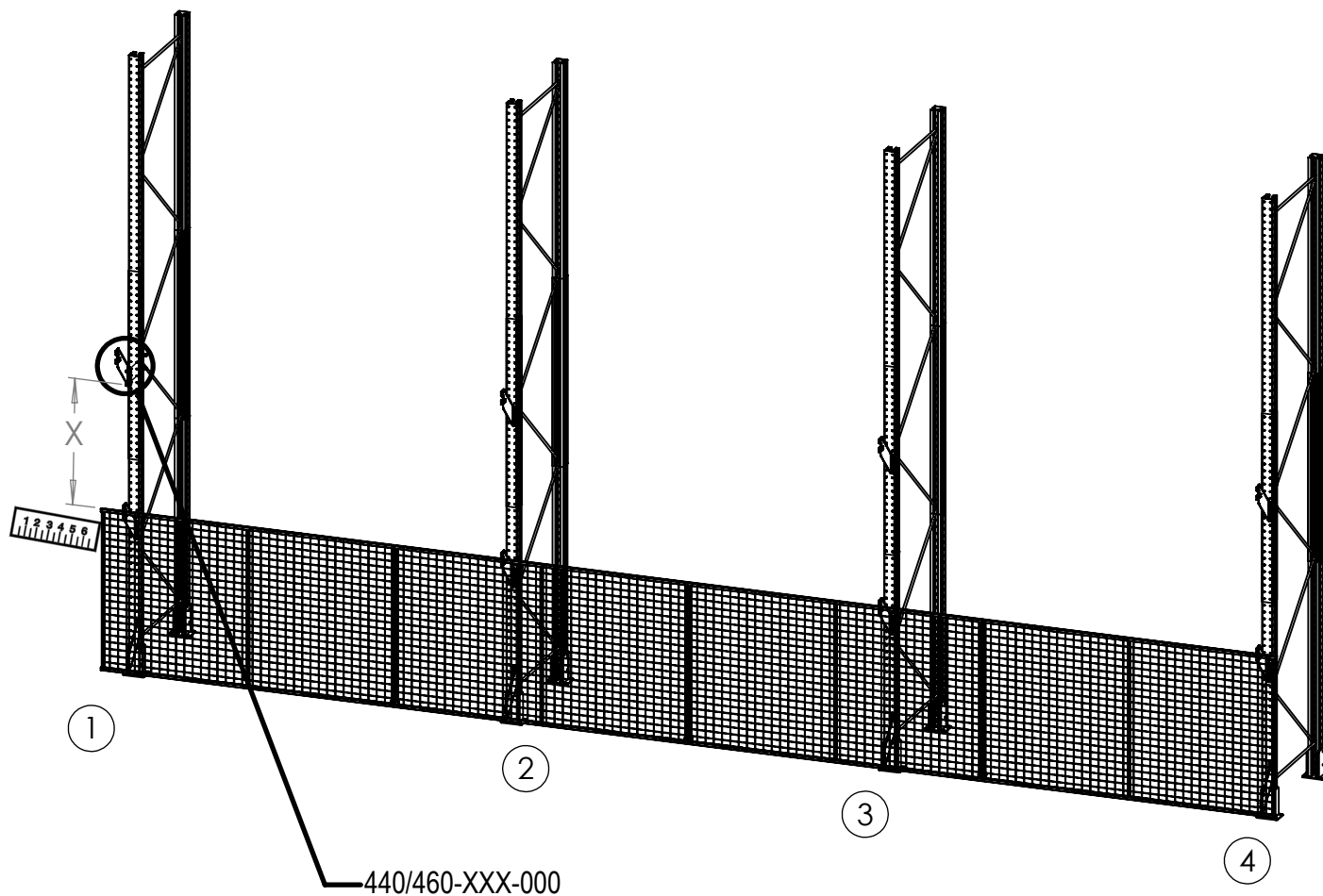

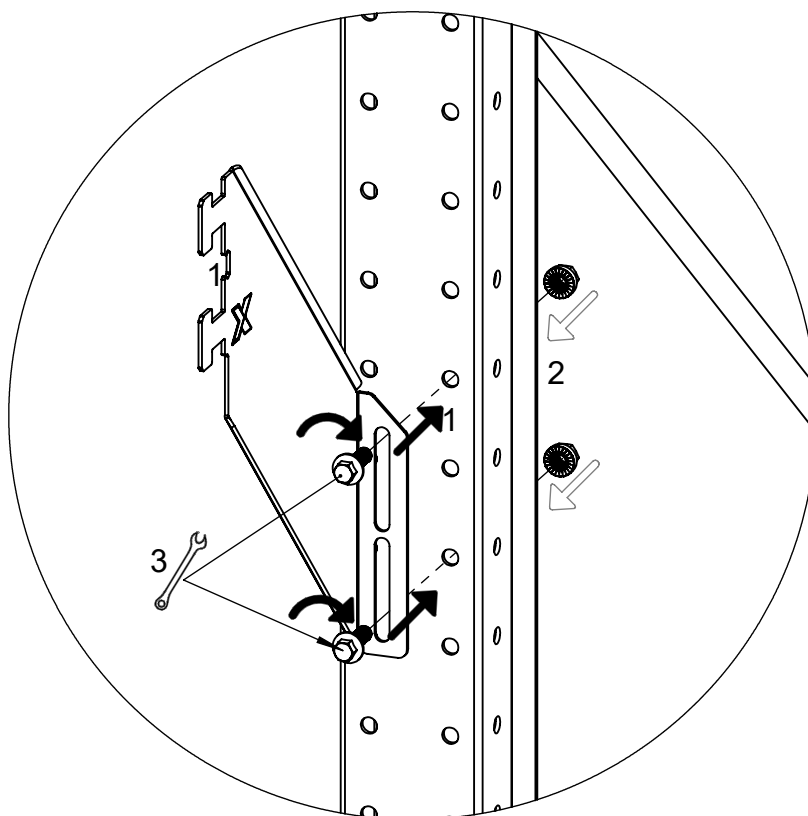
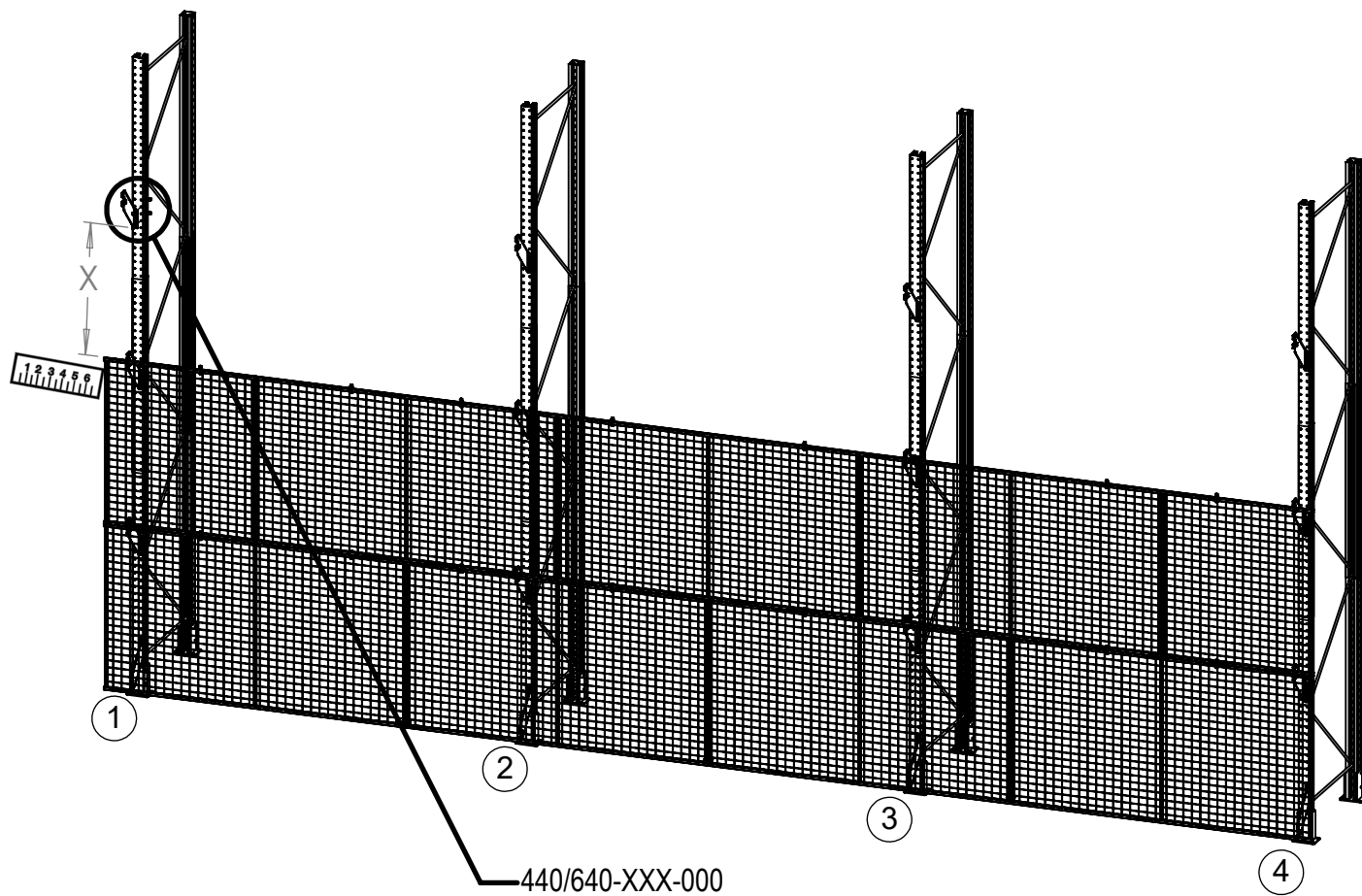

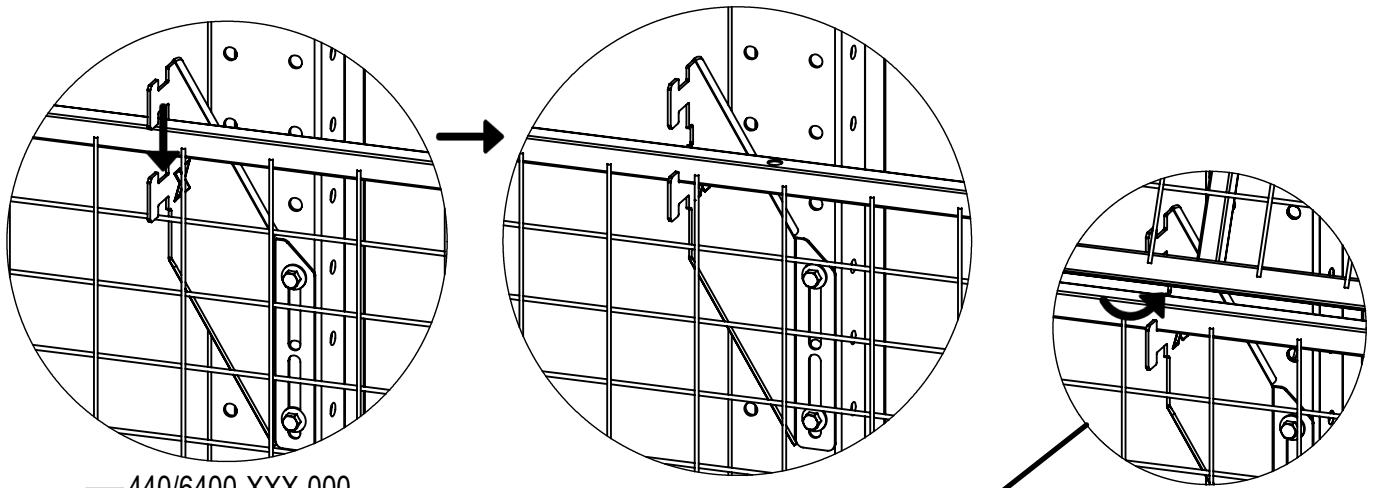

440/6400-XXX-000

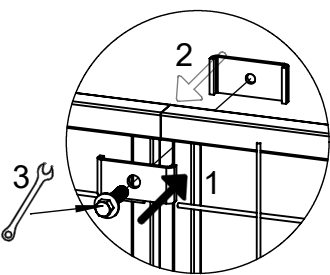
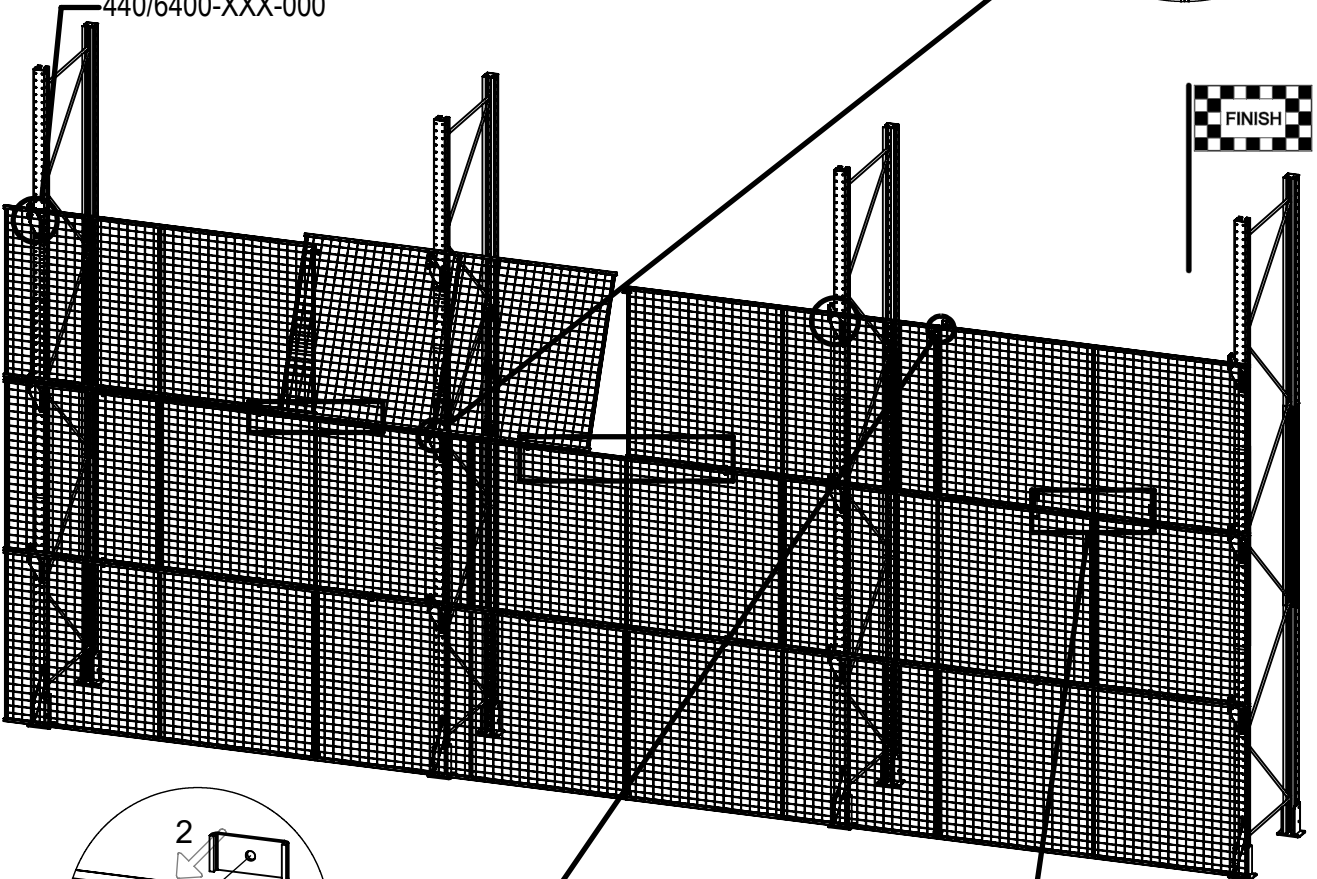

25-9550



21-2301S

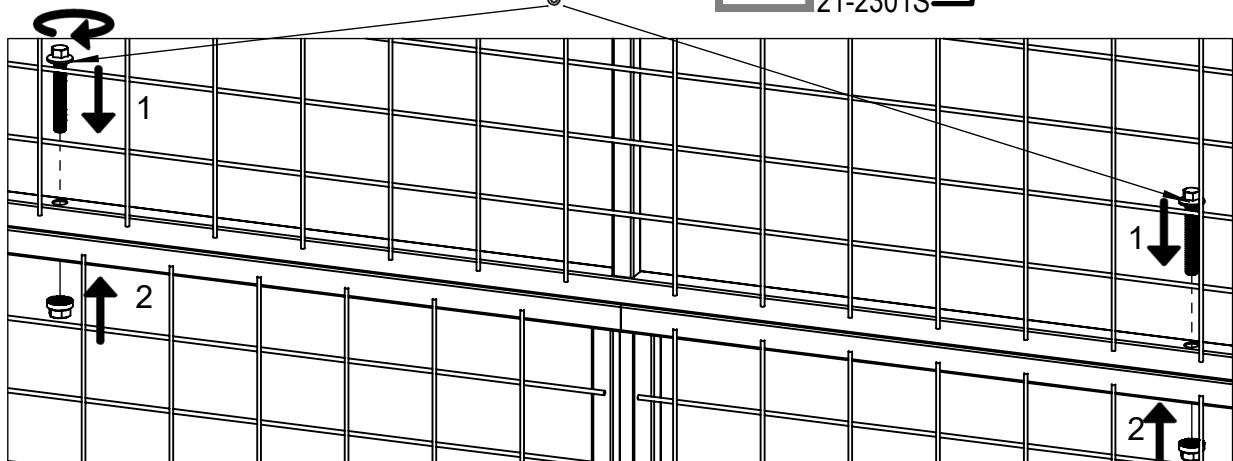

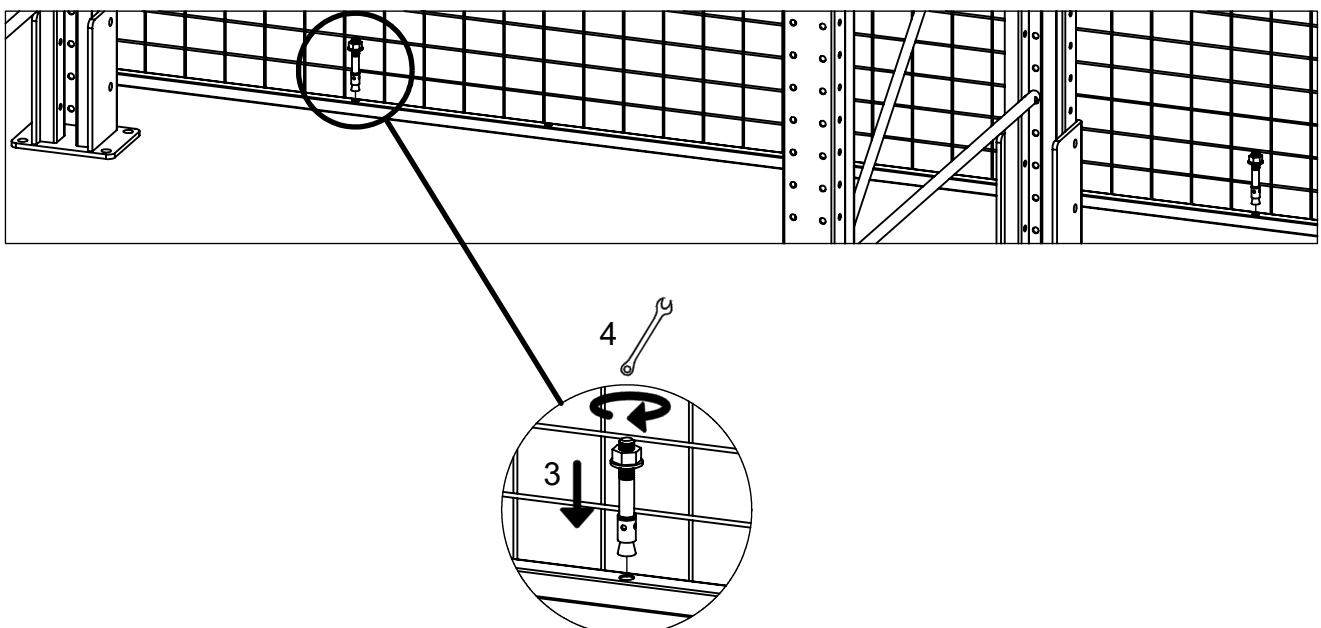
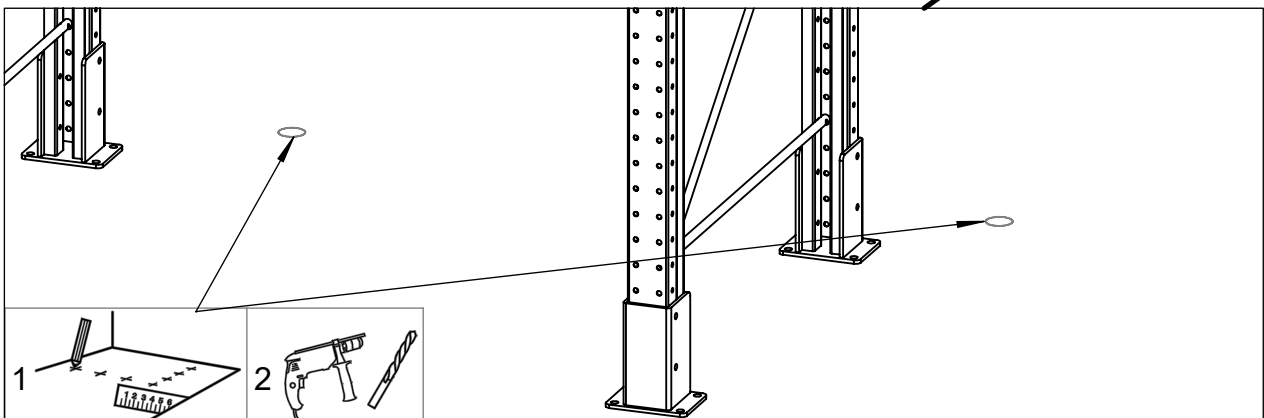
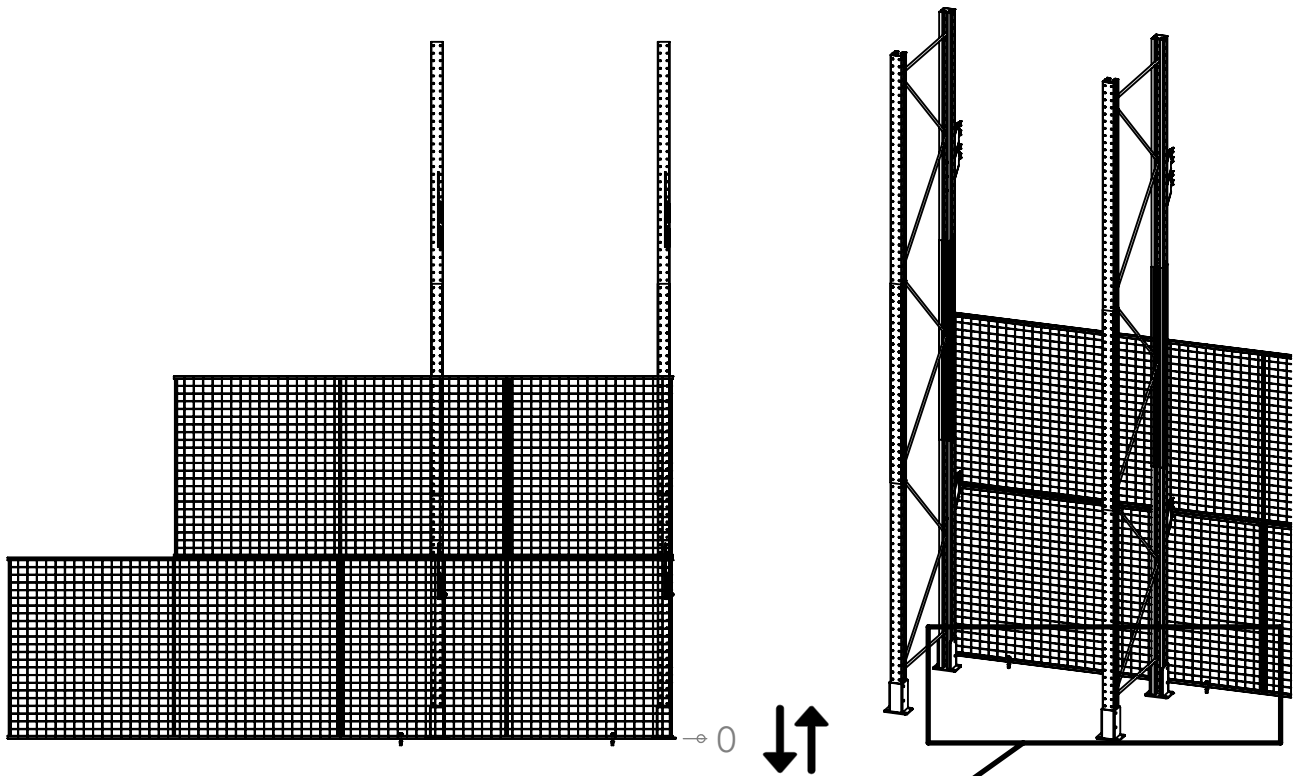

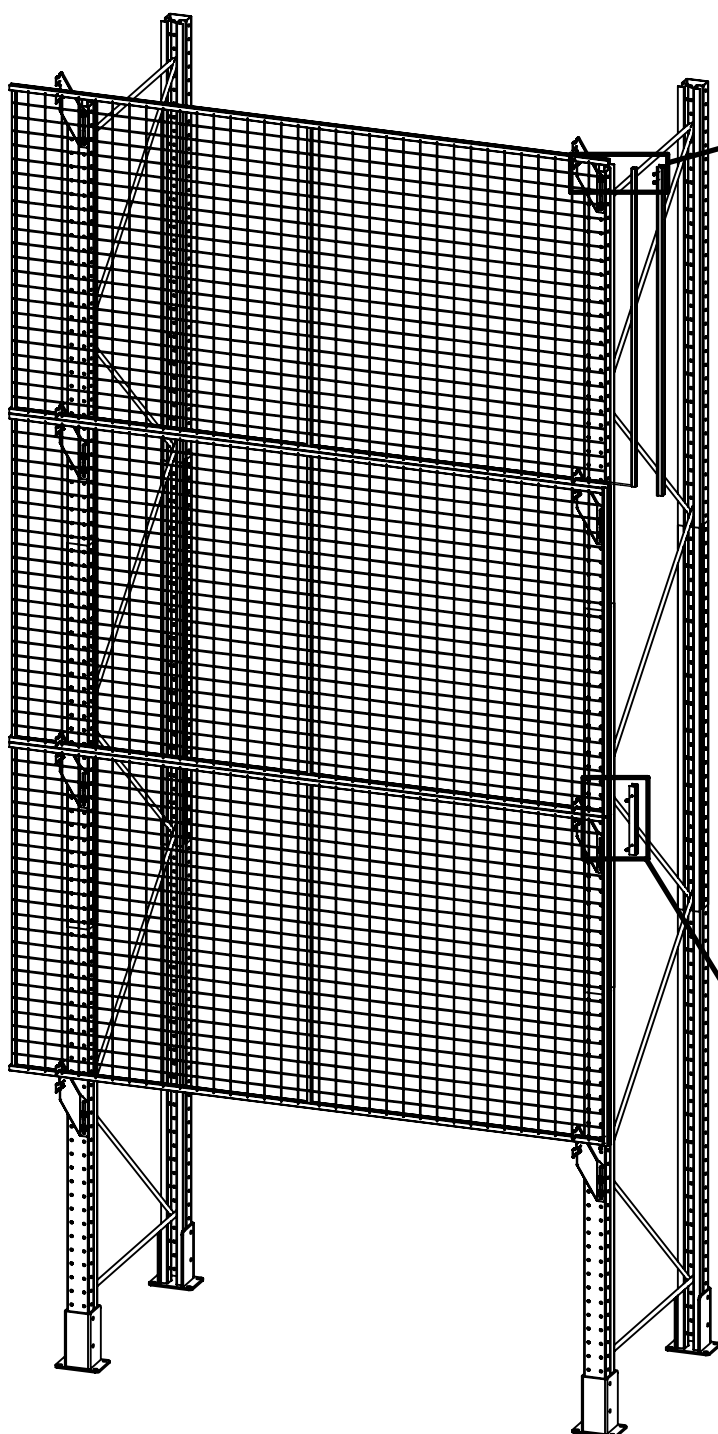
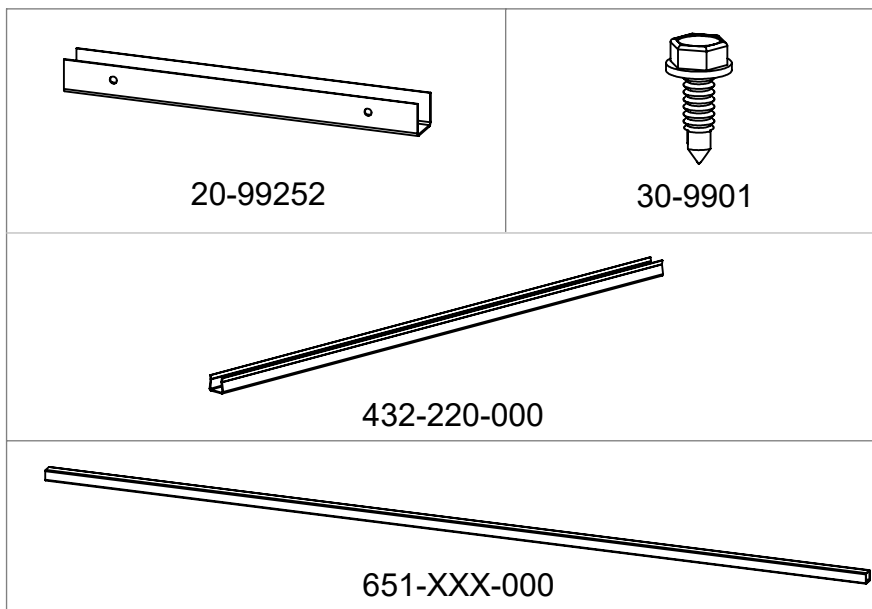
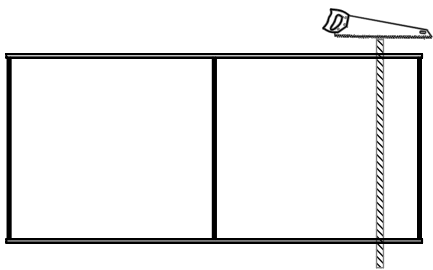

651-XXX-000 / 432-220-000 / 30-9901

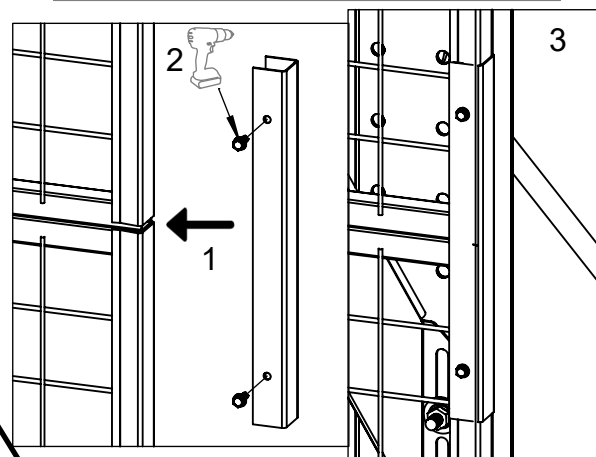
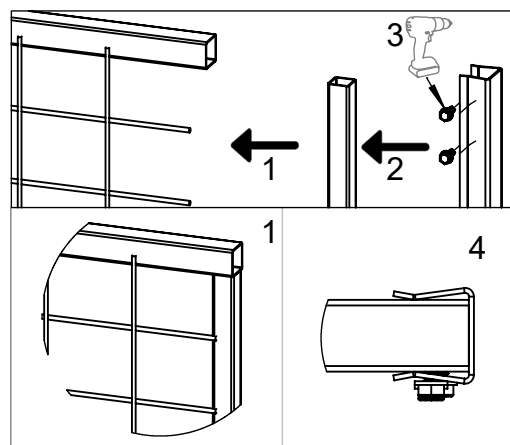

432-220-000 / 20-99251 / 30-9901

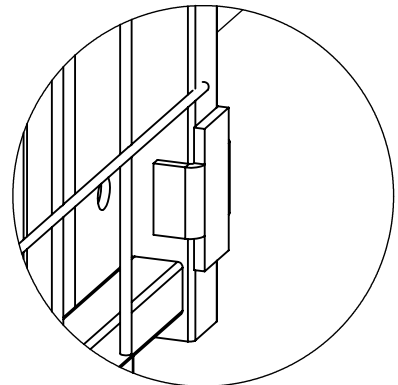
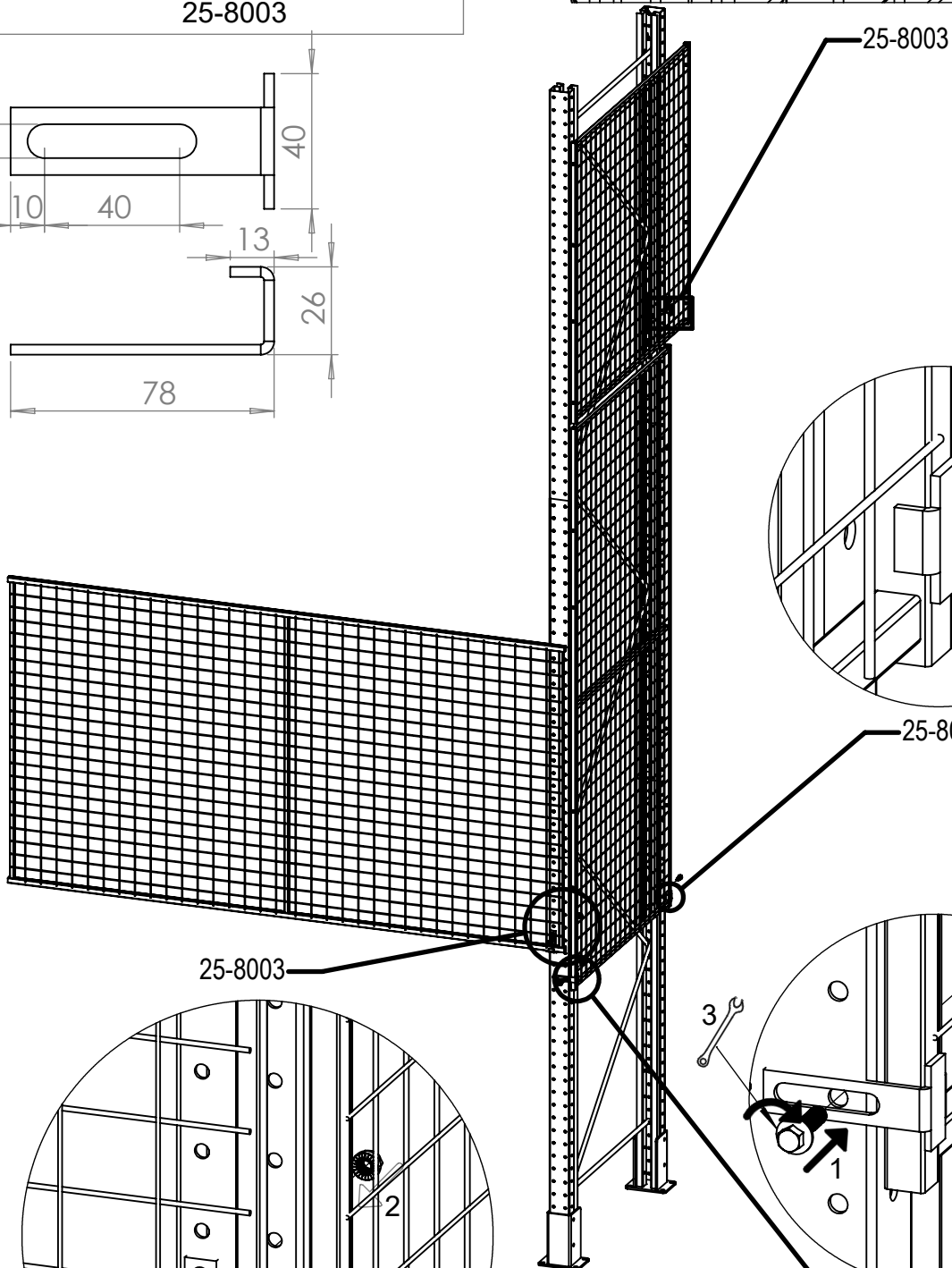
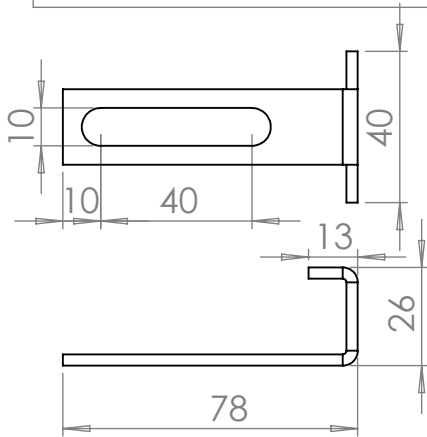
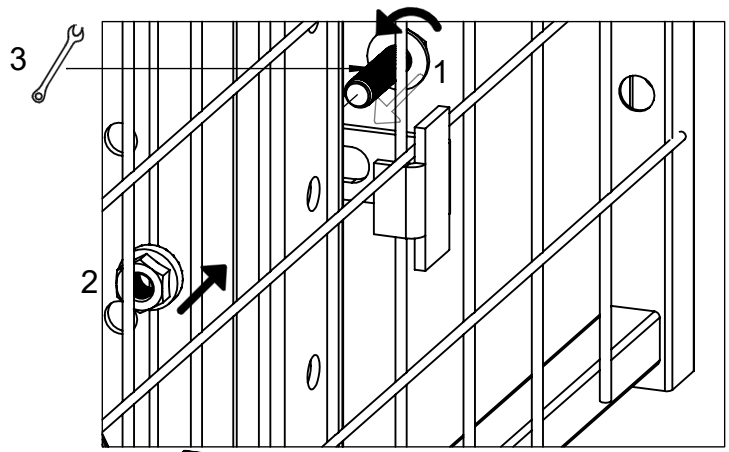
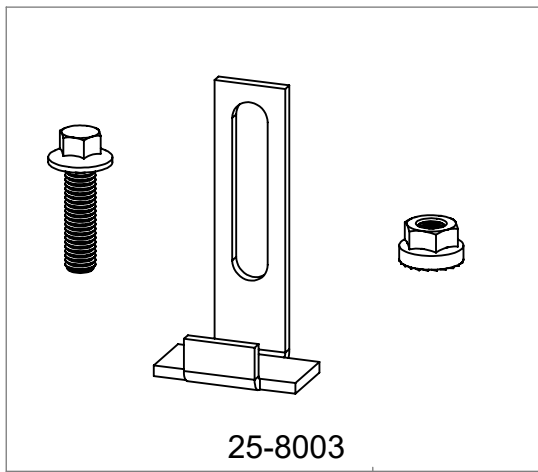

25-8003

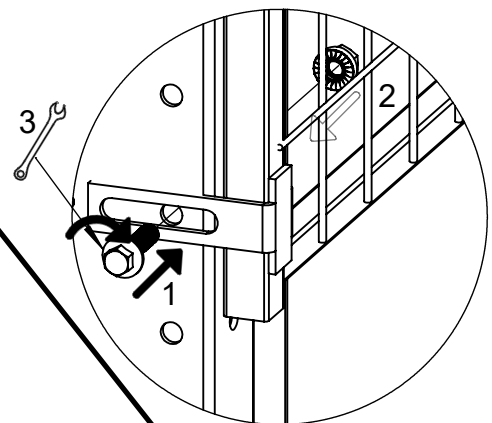
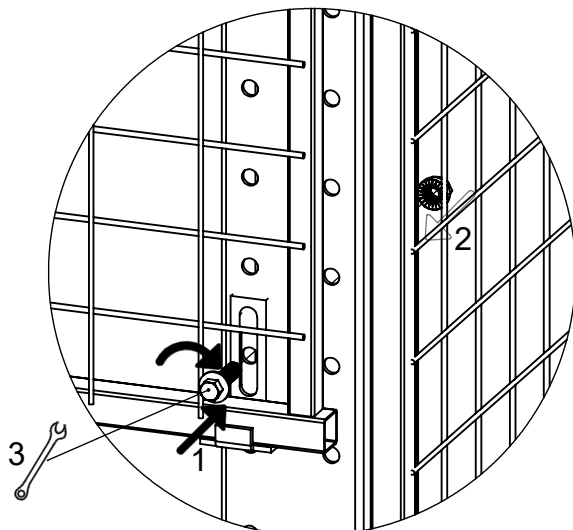

25-8003

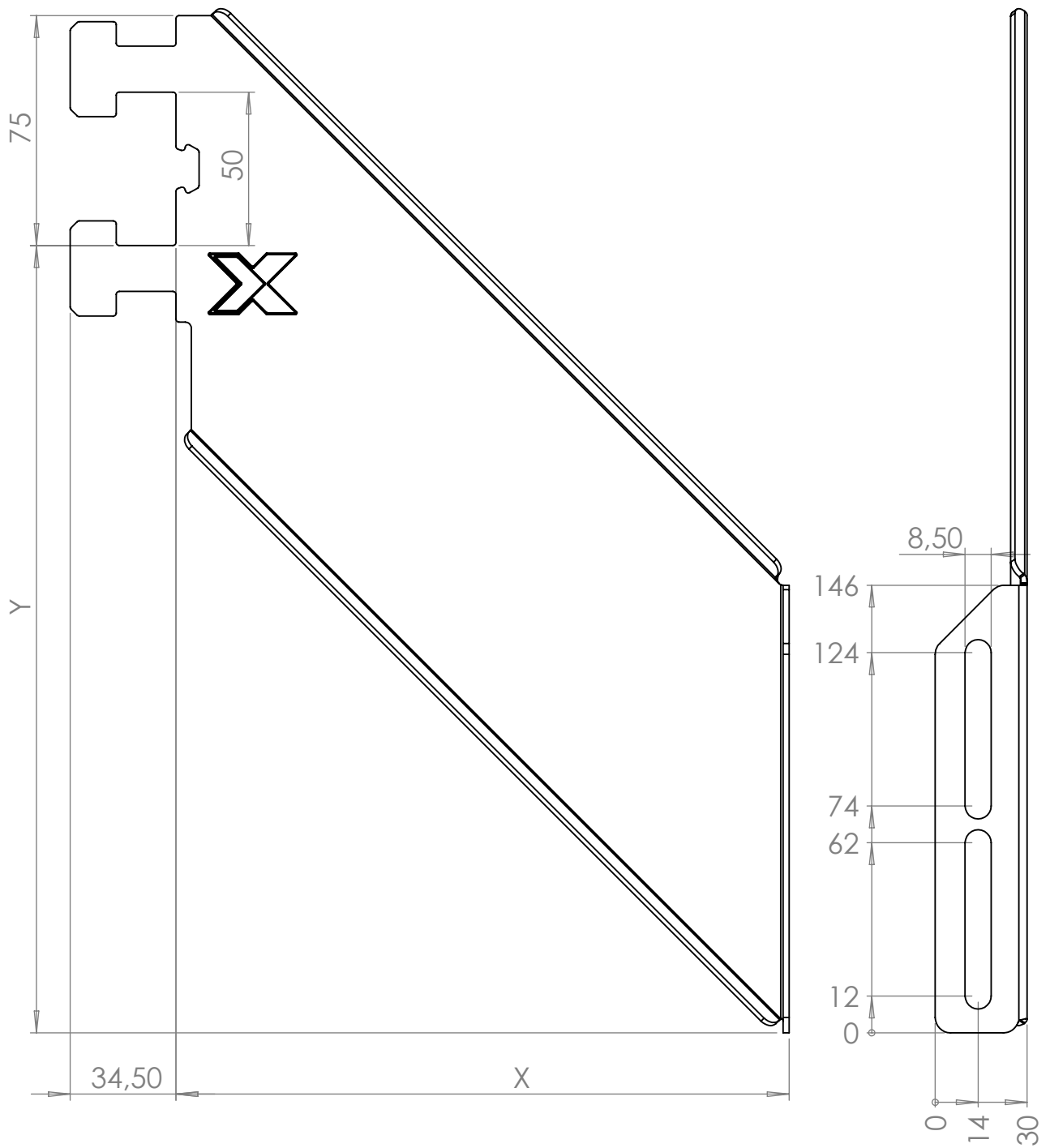

Art No.	X(mm)	Y(mm)	Material thickness
440/640-050-000	50	107	2
440/640-100-000	100	157	2
440/640-125-000	125	182	2
440/640-150-000	150	207	2
440/640-175-000	175	232	2
440/640-200-000	200	257	2
440/640-250-000	250	306	3
440/640-300-000	300	356	3